

## BeO

## FLANGED TERMINATION

### Features:

- ◆ BeO Material
- ◆ DC - 1 GHz Performance
- ◆ 350 Watt Input Power
- ◆ Flange Mount

### General Description:

The T50R0-350-1E is a flanged 50 ohm BeO termination. It has an input power of 350 watts, while maintaining a constant flange temperature of 100°C. It offers a frequency range from DC to 1 GHz.

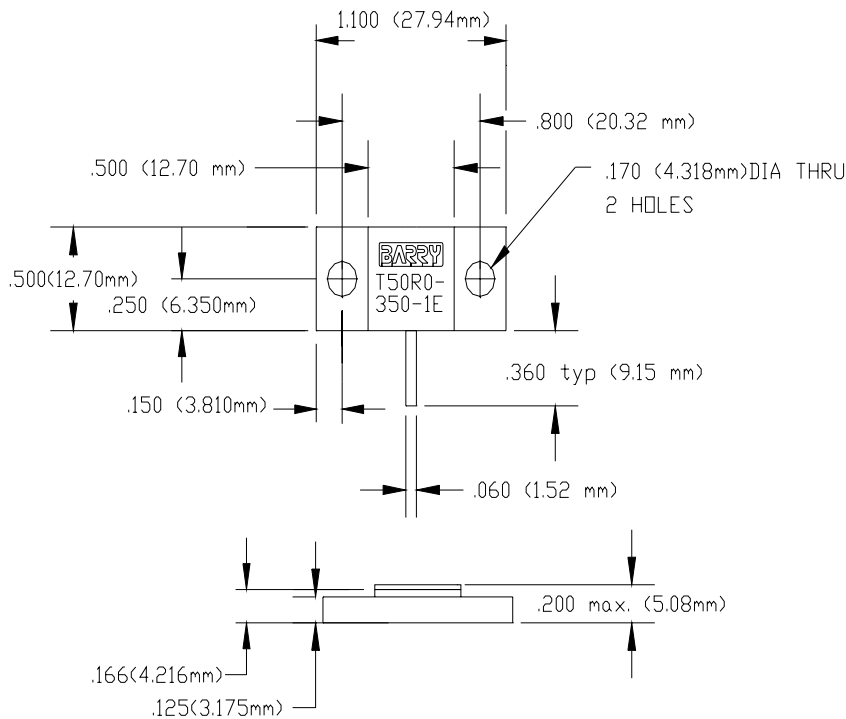

Dimensions in inches (mm)  
Tolerance ±.010 (.254mm)  
unless otherwise stated



DERATING CURVE:

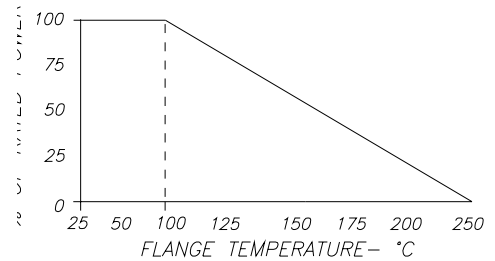

Parameter	Min.	Typ.	Max.	Units
Frequency Range	DC		1	GHz
Return Loss	26.5			dB
Input Power (CW Condition)			350	Watts
Resistance	47.5	50	52.5	Ohms
Flange Temperature			100	°C

Barry Industries reserves the right to change part number and or process without notification.

Barry Industries, Inc., 60 Walton St., Attleboro, MA 02703 T: 508-226-3350 F: 508-226-3317 E-mail: sales@barryind.com

Barry is ISO 9001:2000 Certified by



Origination Date	Revision Date	Rev.
05/21/07	02/12/08	A